



## Retail & Office Spaces

### For Lease

*Van Ness Corridor*

Jay Pon  
415.409.8858  
jpon@jps.net

Mark McNee  
415.967.2637  
mark@mcnee.us

**1230 Sutter St** (Between Van Ness Ave and Polk St)

**1230 Sutter St:**

**Size:** 1,070 SF\*

**Price:** \$2,500/Month/IG

**Basement:**

**Size:** 2,796 SF\*

**Price:** \$1,250/Month/IG

**Zoning:** RC-4; Van Ness Special Use District

- Undergoing seismic retrofit and major renovation for two ground floor commercial spaces and basement. One of the ground floor spaces (1228 Sutter Street) has been leased to an interior designer.
- Ground floor spaces will feature new bathrooms and skylights
- Building appears in the book *San Francisco: A Certain Style*
- Delivery date expected March 2012
- Exposed brick walls; High ceilings

*\*Per architectural drawings*



1345 Mission Street  
San Francisco, CA 94103  
TEL: 415.934.1100

The information contained herein has been obtained from sources we deem reliable but is not guaranteed. Prospective purchasers and/or tenants are advised to independently verify accuracy and to review any disclosure information on file with this office. This property statement is dated February 13, 2012 and replaces any previously dated or undated version. Information on this statement changes periodically; Prospective purchasers and/or tenants are advised to contact our office to ensure they have the most current property statement. Square footage should be verified by purchaser and/or tenant using qualified professionals. To be removed from our distribution list call 415.934.1100. W.J. Britton & Co DRE# 00848717; Jay Pon DRE # 01203843; Mark McNee DRE # 01464307.

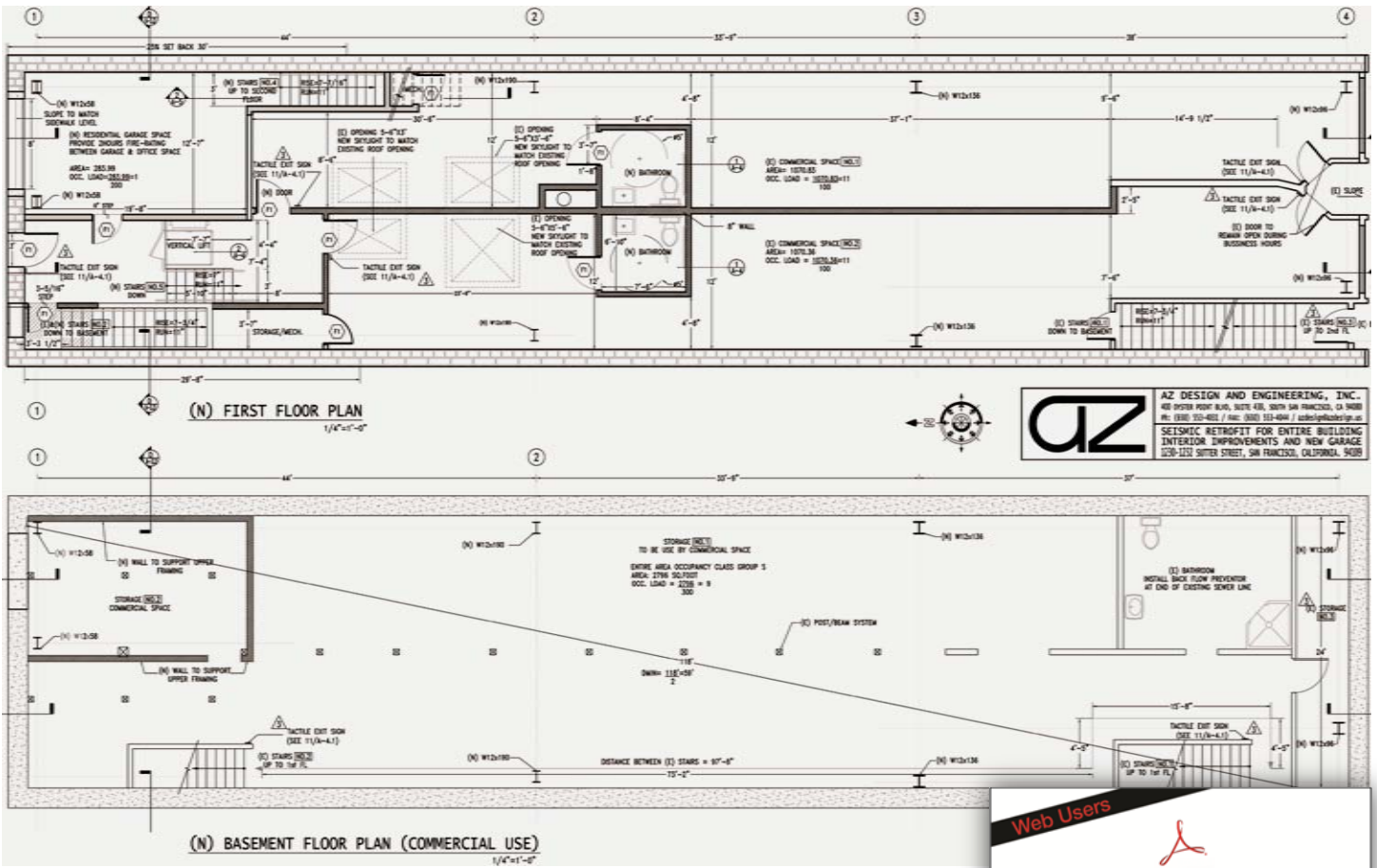

Web Users



[Click Here for PDF Floor Plan](#)



1228 Sutter Street, pictured after renovation



Clean and renovated basement



1345 Mission Street  
San Francisco, CA 94103  
TEL: 415.934.1100

The information contained herein has been obtained from sources we deem reliable but is not guaranteed. Prospective purchasers and/or tenants are advised to independently verify accuracy and to review any disclosure information on file with this office. This property statement is dated February 13, 2012 and replaces any previously dated or undated version. Information on this statement changes periodically; Prospective purchasers and/or tenants are advised to contact our office to ensure they have the most current property statement. Square footage should be verified by purchaser and/or tenant using qualified professionals. To be removed from our distribution list call 415.934.1100. W.J. Britton & Co DRE# 00848717; Jay Pon DRE # 01203843; Mark McNee DRE # 01464307.